



# HiPace® 30 Neo with TC 80, DN 63 CF-F

---



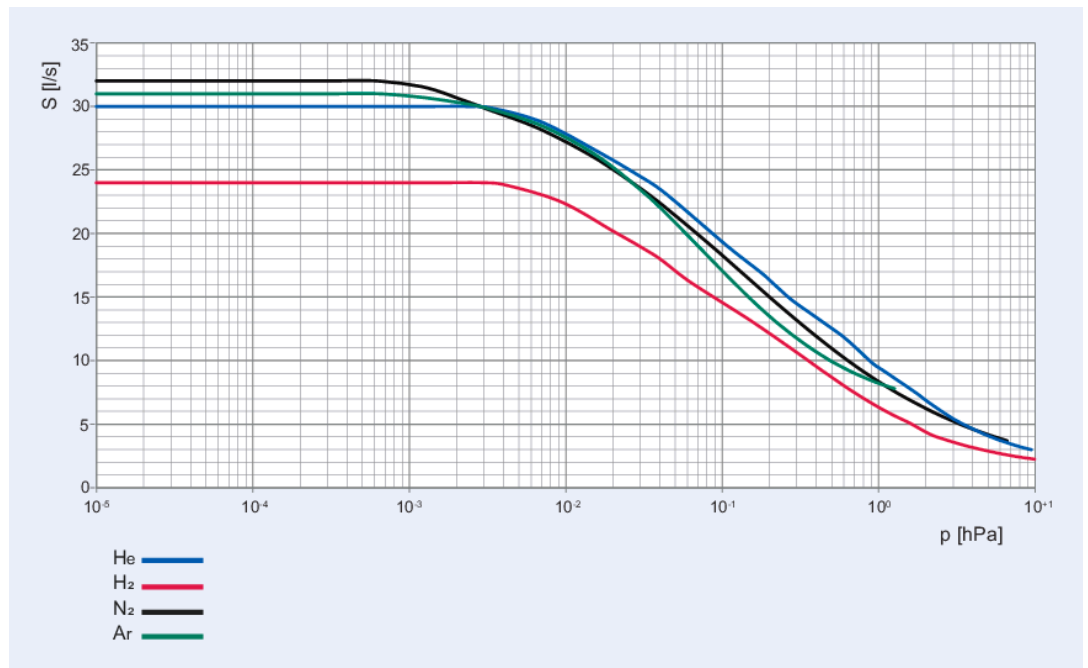

Illustration only

## HiPace® 30 Neo with TC 80, DN 63 CF-F

- Small yet powerful turbopump with a pumping speed of up to 32 l/s for N<sub>2</sub>
- Highest compression in this pumping speed class
- Simple integration into small analytical systems
- Low weight, ideal for portable applications
- Long maintenance intervals for a long life cycle
- For installation in any orientation
- TC 80 integrated electronic drive unit
- Extensive accessories expand the range of applications

## Characteristics



Dimensions

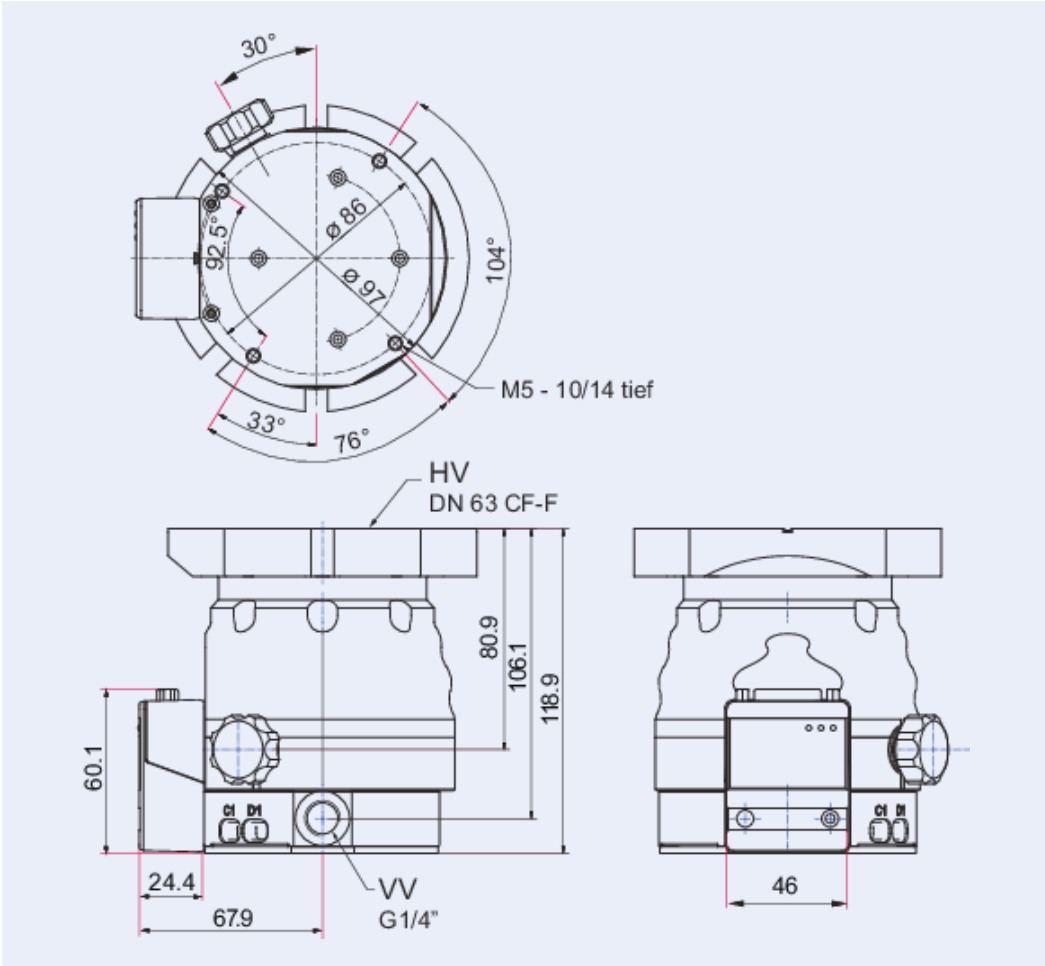

Technical Data	HiPace® 30 Neo with TC 80, DN 63 CF-F
Electronic drive unit	TC 80
Type of electronic drive unit installation	Integrated electronic drive unit
Position of power supply pack	External power supply pack
Cooling method	Natural convection
Pumping speed	72 – 115 m <sup>3</sup> /h
Pumping speed category	108 m <sup>3</sup> /h
Rated current consumption	5 A
Pumping speed for He	30 l/s
Pumping speed for N <sub>2</sub>	32 l/s
Vacuum range min	5 · 10 <sup>-10</sup> hPa
Vacuum range max	5 · 10 <sup>-10</sup> hPa
I/O interfaces	RS-485, Remote
Cooling water temperature	5 – 25 °C
Venting connection	G 1/8"
Bearing	Hybrid
Cooling method, optional	Air (forced convection)   Water
Current max.	5.6 A
Mounting orientation	Arbitrary
Temperature: Storage, max	55 °C
Temperature: Storage, min	-20 °C
Pumping speed for Ar	31 l/s
Pumping speed for H <sub>2</sub>	24 l/s
Input voltage(s)	24 V DC (±10 %)
Emission sound pressure level (EN ISO 2151)	≤48 dB(A)
Permissible axial magnetic field max.	23 mT
Gas throughput at final rotation speed for H <sub>2</sub>	20 hPa·l/s
Gas throughput at final rotation speed for He	7.4 hPa·l/s
Run-up time	65 s
Compression ratio for Ar	1 · 10 <sup>11</sup>
Compression ratio for H <sub>2</sub>	1 · 10 <sup>4</sup>
Compression ratio for He	2 · 10 <sup>5</sup>
Compression ratio for N <sub>2</sub>	1 · 10 <sup>11</sup>
Gas throughput at final rotation speed for N <sub>2</sub>	3.2 hPa·l/s
Gas throughput at final rotation speed for Ar	0.33 hPa·l/s
Fore-vacuum max. for N <sub>2</sub>	20 hPa   15 Torr   20 mbar

Pumping speed for He	30 l/s
Pumping speed for N <sub>2</sub>	32 l/s
Rotation speed ±2 %	90,000 rpm   90,000 min <sup>-1</sup>
Weight	2.9 kg   6.39 lb
Pumping speed for Ar	31 l/s
Pumping speed for H <sub>2</sub>	24 l/s
Compression ratio for N <sub>2</sub>	1 · 10 <sup>11</sup>
Compression ratio for H <sub>2</sub>	1 · 10 <sup>4</sup>
Compression ratio for He	2 · 10 <sup>5</sup>
Compression ratio for Ar	1 · 10 <sup>11</sup>
Permissible radial magnetic field max.	5 mT
Fore-vacuum max. for N <sub>2</sub>	20 hPa
Cooling water flow	75 l/h
Power consumption max.	110 W
03 Vacuum range	High Vacuum   Ultra-high Vacuum
Connection flange	DN 63 CF-F / G ¼" Thread
Rotation speed variable	50 – 100 %
Rotation speed ± 2 %	90,000 rpm
Weight	2.9 kg
Gas throughput at full rotational speed, short term, for N <sub>2</sub>	7.5 hPa·l/s
Gas throughput at full rotational speed, short term, for He	12.5 hPa·l/s
Gas throughput at full rotational speed, short term, for H <sub>2</sub>	20 hPa·l/s
Gas throughput at full rotational speed, short term, for Ar	3 hPa·l/s
Connection flange (in)	DN 63 CF-F
Connection flange (out)	G ¼"

<b>Order number</b>	<b>HiPace® 30 Neo with TC 80, DN 63 CF-F</b>
HiPace® 30 Neo with TC 80, DN 63 CF-F	PM P090 316 10



伯东企业（上海）有限公司  
HAKUTO ENTERPRISES (SHANGHAI) LTD.  
TEL: (86) 21-5046 3511

## 上海伯东 -- 您理想的真空合作伙伴！

伯东公司成立于 1953 年，外企上市企业，全球范围内有一千七百名员工，集团年营业额约为 100亿人民币。

伯东公司在国内主要城市：上海，北京，苏州，广州，深圳，成都及厦门设有营业据点。

上海伯东真空产品事业部已累计为超过 10,000 家企业提供真空服务

**我们致力于追求高品质的服务，为您提供一流的服务及一流产品：**

**品质保障：**国际知名品牌指定授权代理商，所有产品及部件保证 100% 原厂原装进口

**现货交期快：**部分产品有现货，下单立即发货（现货数量有限，实际情况请联系销售工程师）

**卓越维修能力：**伯东工程师拥有10年以上维修经验，且受国外专业培训，拥有完全的拆解，维修，校正能力。

**完美服务质量：**原装进口检测设备全方位寻找问题症结及全方面的性能测试，确保完美的服务质量



伯东企业（上海）有限公司 销售及售后服务中心

上海浦东新区新金桥路1888号36号楼7楼702室

电话：+86-21-5046-3511 / 139-1883-7267

传真：+86-21-5046-1490

官网：<http://www.hakuto-vacuum.cn>

