



Okta 4000

Roots pump with a pumping speed of 2,160 to 6,490 m³/h:





Similar Image

Okta 4000, Roots pump without motor

- High-performance Roots pump with a pumping speed of 2160 to 6490 m³/h
- Without motor (coupling and motor lantern are included in delivery)
- No thermal overload thanks to integral overflow valve
- For applications in the low and medium vacuum

Okta = Standard pumps with radial shaft sealing rings, housing parts made of gray cast iron or nodular graphite cast iron, flange connection in accordance with ISO-F

Okta M = Standard pumps, hermetically sealed thanks to magnetic coupling, housing parts made of gray cast iron or nodular graphite cast iron, flange connection in accordance with ISO-F

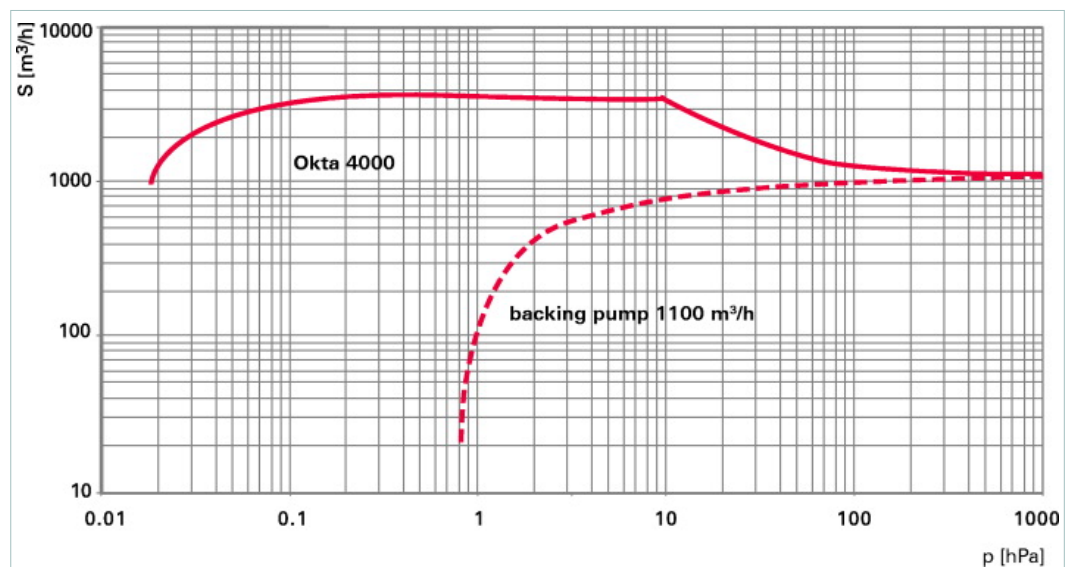

Dimensions

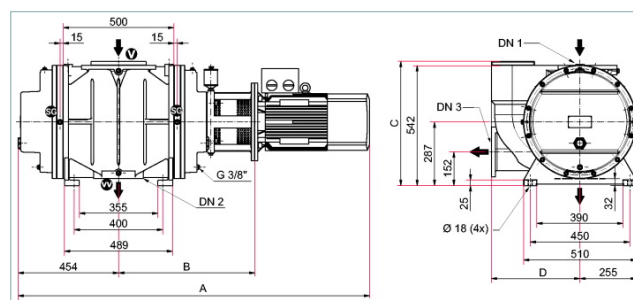

| | |
|------|---------------------------|
| B | 616 mm |
| C | 560 mm |
| D | 400 mm |
| DN 1 | DN 250 ISO-F/DN 250 PN 16 |
| DN 2 | DN 160 ISO-F/DN 150 PN 16 |
| DN 3 | DN 160 ISO-F/DN 150 PN 16 |

| Technical Data | Okta 4000, Roots pump without motor |
|---|-------------------------------------|
| Ambient temperature | 5-40 °C 41-104 °F 278-313 K |
| Cooling method, standard | Air |
| Differential pressure at the overflow valve | 25 hPa 18.75 Torr 25 mbar |
| Emission sound pressure level (EN ISO 2151) at intake pressure 10 hPa | 79 dB (A) |
| Emission sound pressure level (EN ISO 2151) at intake pressure 1 hPa | 74 dB (A) |
| Flange (in) | DN 250 ISO-F/DN 250 PN 16 |
| Flange (out) | DN 160 ISO-F/DN 150 PN 16 |

| Technical Data | Okta 4000, Roots pump without motor |
|---------------------------------|---|
| Leak rate | $1 \cdot 10^{-3} \text{ Pa m}^3/\text{s}$ $7.5 \cdot 10^{-3} \text{ Torr l/s}$ $1 \cdot 10^{-2} \text{ mbar l/s}$ |
| Nominal pumping speed | 2160-6490 m^3/h |
| Nominal pumping speed at 50 Hz | 4325 m^3/h |
| Nominal pumping speed at 60 Hz | 5190 m^3/h |
| Nominal rotation speed at 50 Hz | 3000 min^{-1} |
| Nominal rotation speed at 60 Hz | 3600 min^{-1} |
| Operating fluid | P3 |
| Operating fluid filling | 6.8 l |
| Protection category | IP 55 |
| Rotation speed | from 1500 to 4500 min^{-1} |
| Rotation speed max. | 4500 min^{-1} |
| Rotation speed min. | 1500 min^{-1} |
| Version | Standard without motor |
| Weight: without motor | 550 kg 1,212.53 lb |

| Order number | |
|--------------|------------|
| Okta 4000 | PP W71 001 |

| Accessories | |
|---|---------------|
| Accessories | |
| Oil level monitoring 20-250 V AC for Okta 250 / M / Okta 500 / M / Okta 1000 / M / Okta 2000 / M / Okta 4000 / M / Okta 6000 / M, G 1 1/4 | PK 004 930 -U |
| Oil level monitoring 24 V DC for Okta 250 / M / Okta 500 / M / Okta 1000 / M / Okta 2000 / M / Okta 4000 / M / Okta 6000 / M, G 1 1/4 | PK 005 639 -U |
| Adjusting elements for fastening the feet. | |
| Setting elements for foot mounting for Okta 2000 / M / Okta 4000 / M / Okta 6000 / M / Okta 1500 G, 29 mm | PP 144 118 -T |
| Blank flange sets | |
| Blank flange set (Stainless steel) for Okta 4000 / M / ATEX / Okta 6000 / M, DN PN16/PN10 | PP 045 889 -T |
| Blank flange set (Stainless steel) for Okta 4000 / M / Okta 6000 / M, DN ISO-K | PP 045 888 -T |
| Blank flange set for Okta 4000 / M / Okta 6000 / M, Stainless steel | PP 045 887 -T |
| DN ISO-F | |
| Mounting bolts (Stainless steel) for Okta 4000 / M / Okta 4000 / M, Okta 6000 / M, DN ISO-F | PP 045 876 -T |
| Mounting bolts (Zinc-plated Steel) for Okta 4000 / M / Okta 4000 / M, Okta 6000 / M, DN ISO-F | PP 045 875 -T |
| DN ISO-K | |
| Claw set (Stainless steel) for Okta 4000 / M / Okta 4000 / M, Okta 6000 / M, DN ISO-K | PP 045 881 -T |
| Claw set (Zinc-plated Steel) * for Okta 4000 / M / Okta 4000 / M, Okta 6000 / M, DN ISO-K | PP 045 883 -T |
| Claw set (Zinc-plated Steel) for Okta 4000 / M / Okta 4000 / M, Okta 6000 / M, DN ISO-K | PP 045 882 -T |
| DN PN16/PN10 | |
| Mounting bolts (Zinc-plated Steel) for Okta 4000 / M / ATEX / Okta 4000 / M / ATEX, Okta 6000 / M, DN PN16/PN10 | PP 045 884 -T |
| Frequency converter | |
| Frequency converter (Complete with control box) Okta 4000 / M | PP 078 284 -T |
| Gear chamber evacuation | |
| Gear box exhaust (Flexible hose) for Okta 4000 / M / Okta 6000 / M, G 3/8 (3x) | PP 045 892 -T |
| Gear box exhaust (Plastic hose) for Okta 4000 / M / Okta 6000 / M, G 3/8 (3x) | PP 045 891 -T |
| Oil compensating line (with oil level monitoring) | |
| Oil compensating line with oil level monitoring for Okta 250 / M / Okta 500 / M, G 3/8 (4x), G 1 1/4 (1x) | PP 031 449 -T |
| Purge gas kit | |
| Sealing gas kit for Okta 250 / M / Okta 500 / M / Okta 1000 / M / Okta 2000 / M / Okta 4000 / M / Okta 6000 / M / Okta 8000 / Okta 1500 G / Okta 4000 G / Okta 8000 G, G 3/8 (4x) | PP 027 401 -T |
| Sealing kits | |
| Centering ring with outer ring for vacuum flange for Okta 1000 / M / Okta 2000 / M, DN ISO-F | PF 303 116 -T |
| Centering ring with outer ring for vacuum flange for Okta 4000 / M / Okta 6000 / M / Okta 4000 G, DN ISO-F | PF 303 125 -T |
| Seal kit (FKM) for Okta 4000 / M / ATEX, DN PN16/PN10 | PP 045 890 -T |

| Accessories | |
|--|---------------|
| Splinter shield | |
| Splinter shield for Okta 4000/4000 M/4000 G/6000/6000 M | PP 031 136 -X |
| Splinter shield for Okta 4000 / 6000, hermetically sealed | PP 031 137 -X |
| Sprayer | |
| Sprayer DN ISO-F for Okta 4000 / M / Okta 6000 / M / Okta 4000 G | PP 045 872 -T |
| Sprayer DN PN16/PN10 for Okta 4000 / M / Okta 6000 / M | PP 031 245 -T |
| Temperature sensor | |
| Temperature sensor for Okta 250 / M / Okta 500 / M / Okta 1000 / M / Okta 2000 / M / Okta 4000 / M / Okta 6000 / M / Okta 500 G / Okta 1500 G / Okta 4000 G, G 3/8 | PP 041 457 -T |
| Consumables | |
| P3, mineral oil, 1 l | PK 001 106 -T |
| P3, mineral oil, 5 l | PK 001 107 -T |