



Okta 1000

Roots pump with a pumping speed of 590 to 1,775 m³/h:





Similar Image

Okta 1000, Roots pump without motor

- High-performance Roots pump with a pumping speed of 590 to 1,775 m³/h
- Without motor (coupling and motor lantern are included in delivery)
- No thermal overload thanks to integral overflow valve
- For applications in the low and medium vacuum

Okta = Standard pumps with radial shaft sealing rings, housing parts made of gray cast iron or nodular graphite cast iron, flange connection in accordance with ISO-F

Okta = Standard pumps, hermetically sealed thanks to magnetic coupling, housing parts made of gray cast iron or nodular graphite cast iron, flange connection in accordance with ISO-F

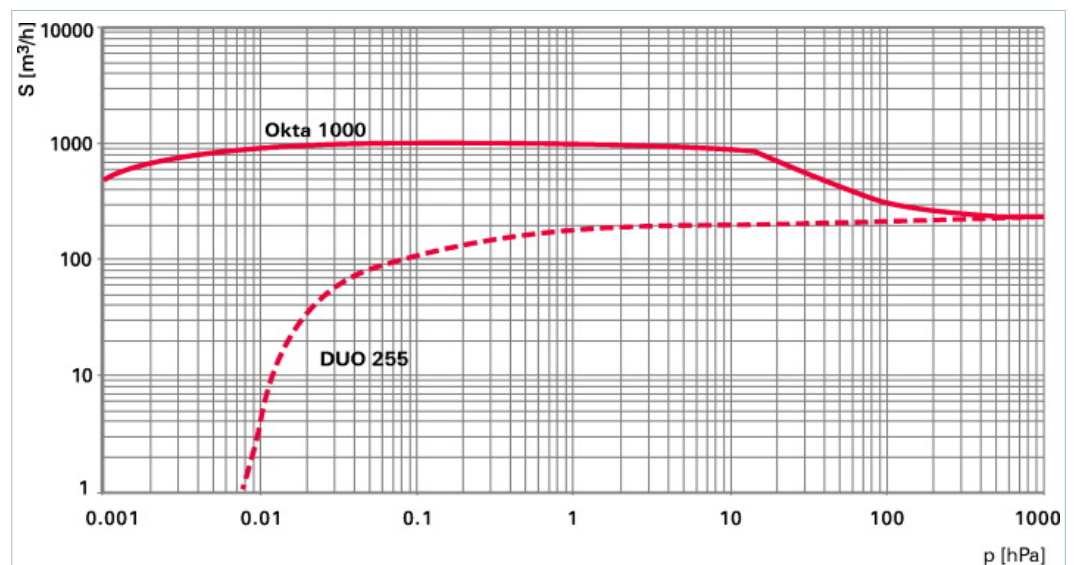

Dimensions

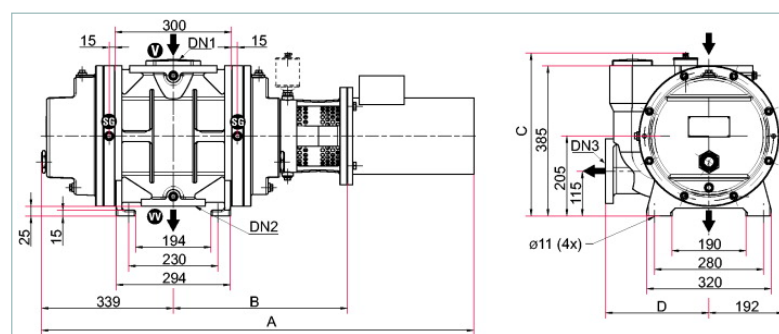

B	448 mm
C	418 mm
D	266 mm
DN 1	DN 160 ISO-F
DN 2	DN 100 ISO-F
DN 3	DN 100 ISO-F

Technical Data	Okta 1000, Roots pump without motor
Ambient temperature	5-40 °C 41-104 °F 278-313 K
Cooling method, standard	Air
Differential pressure at the overflow valve	45 hPa 33.75 Torr 45 mbar
Emission sound pressure level (EN ISO 2151) at intake pressure 10 hPa	75 dB (A)
Emission sound pressure level (EN ISO 2151) at intake pressure 1 hPa	72 dB (A)
Flange (in)	DN 160 ISO-F
Flange (out)	DN 100 ISO-F

Technical Data	Okta 1000, Roots pump without motor
Leak rate	$< 1 \cdot 10^{-3} \text{ Pa m}^3/\text{s}$ $< 7.5 \cdot 10^{-3} \text{ Torr l/s}$ $< 1 \cdot 10^{-2} \text{ mbar l/s}$
Nominal pumping speed	590-1775 m ³ /h
Nominal pumping speed at 50 Hz	1180 m ³ /h
Nominal pumping speed at 60 Hz	1420 m ³ /h
Nominal rotation speed at 50 Hz	3000 min ⁻¹
Nominal rotation speed at 60 Hz	3600 min ⁻¹
Operating fluid	P3
Operating fluid filling	2.9 l
Protection category	IP 55
Rotation speed	from 1,500 to 4,500 min ⁻¹
Rotation speed max.	4500 min ⁻¹
Rotation speed min.	1500 min ⁻¹
Version	Standard without motor
Weight: without motor	215 kg 473.99 lb

Order number	
Okta 1000	PP W41 001

Accessories	
Accessories	
Oil level monitoring 20-250 V AC for Okta 250 / M / Okta 500 / M / Okta 1000 / M / Okta 2000 / M / Okta 4000 / M / Okta 6000 / M, G 1 1/4	PK 004 930 -U
Oil level monitoring 24 V DC for Okta 250 / M / Okta 500 / M / Okta 1000 / M / Okta 2000 / M / Okta 4000 / M / Okta 6000 / M, G 1 1/4	PK 005 639 -U
Adjusting elements for fastening the feet.	
Setting elements for foot mounting for Okta 250 / M / Okta 500 / M / Okta 1000 / M, 35 mm	PP 041 454 -T
Blank flange sets	
Blank flange set (Stainless steel) for Okta 1000 / M / ATEX / Okta 2000 / M / ATEX, DN PN16/PN10	PP 043 885 -T
Blank flange set (Stainless steel) for Okta 1000 / M / Okta 2000 / M, DN ISO-K	PP 043 884 -T
Blank flange set for Okta 1000 / M / Okta 2000 / M, Stainless steel	PP 043 883 -T
DN ISO-F	
Mounting bolts (Stainless steel) for Okta 1000 / M / Okta 1000 / M, Okta 2000 / M, DN ISO-F	PP 043 878 -T
Mounting bolts (Zinc-plated Steel) for Okta 1000 / M / Okta 1000 / M, Okta 2000 / M, DN ISO-F	PP 043 873 -T
DN ISO-K	
Claw set (Stainless steel) for Okta 1000 / M / Okta 1000 / M, Okta 2000 / M, DN ISO-K	PP 043 879 -T
Claw set (Zinc-plated Steel) * for Okta 1000 / M / Okta 1000 / M, Okta 2000 / M, DN ISO-K	PP 043 881 -T
Claw set (Zinc-plated Steel) for Okta 1000 / M / Okta 1000 / M, Okta 2000 / M, DN ISO-K	PP 043 880 -T
DN PN16/PN10	
Mounting bolts (Zinc-plated Steel) for Okta 1000 / M / ATEX, DN PN16/PN10	PP 043 882 -T
Frequency converter	
Frequency converter (Complete with control box) Okta 1000 / M	PP 078 300 -T
Gear chamber evacuation	
Gear box exhaust (Flexible hose) for Okta 1000 / M, G 3/8 (3x)	PP 043 888 -T
Gear box exhaust (Plastic hose) for Okta 1000 / M, G 3/8 (3x)	PP 043 887 -T
Oil compensating line (with oil level monitoring)	
Oil compensating line with oil level monitoring for Okta 250 / M / Okta 500 / M, G 3/8 (4x), G 1 1/4 (1x)	PP 031 447 -T
Purge gas kit	
Sealing gas kit for Okta 250 / M / Okta 500 / M / Okta 1000 / M / Okta 2000 / M / Okta 4000 / M / Okta 6000 / M / Okta 8000 / Okta 1500 G / Okta 4000 G / Okta 8000 G, G 3/8 (4x)	PP 027 401 -T
Sealing kits	
Centering ring with outer ring for vacuum flange for Okta 1000 / M / Okta 2000 / M, DN ISO-F	PF 303 116 -T
Centering ring with outer ring for vacuum flange for Okta 500 / M / Okta 500 G, DN ISO-F	PF 303 110 -T
Seal kit (FKM) for Okta 1000 / M / ATEX, DN PN16/PN10	PP 043 886 -T
Splinter shield	
Splinter shield for Okta 1000/1000 M/1500 G/2000/2000 M	PP 031 114 -X
Splinter shield for Okta 1000/2000 AD-Series	PP 031 115 -X

Accessories	
Sprayer	
Sprayer DN ISO-F for Okta 1000 / M / Okta 2000 / M	PP 031 252 -T
Sprayer DN PN16/PN10 for Okta 1000 / M / Okta 2000 / M / Okta 1500 G	PP 031 243 -T
Temperature sensor	
Temperature sensor for Okta 250 / M / Okta 500 / M / Okta 1000 / M / Okta 2000 / M / Okta 4000 / M / Okta 6000 / M / Okta 500 G / Okta 1500 G / Okta 4000 G, G 3/8	PP 041 457 -T
Consumables	
P3, mineral oil, 1 l	PK 001 106 -T
P3, mineral oil, 5 l	PK 001 107 -T