



# Pirani/Cold Cathode combination MPT 200 ( $5 \cdot 10^{-9}$ – 1000 hPa)

Der MPT 200 gauge affords accurate measurements from  $5 \cdot 10^{-9}$  hPa to atmospheric pressure. With its rugged metallic case and digital interface it is particularly suited for operation in vacuum and other systems.





Similar Image

## MPT 200, DN 40 CF-F, RS-485, analog

- $5 \cdot 10^{-9}$  to 1000 hPa
- Insensitive to gas inrush
- Customizable to vacuum application
- Profibus DP Interface (optional)
- Analog output and set points (optional)

PB = additionally with Profibus-DP interface

AR = additionally with analogue output and two switch-points

### Dimensions

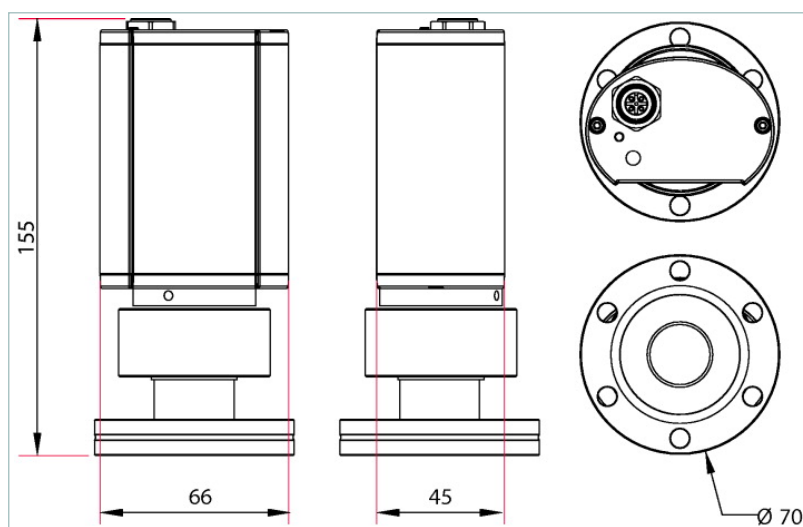

DN 1 DN 40 CF-F

Technical Data	MPT 200, DN 40 CF-F, RS-485, analog
Accuracy: % of measurement	$1 \cdot 10^{-8} - 2 \cdot 10^{-3}$ hPa: $\pm 25\%$ , $2 \cdot 10^{-3} - 10$ hPa: $\pm 10\%$ , $10 - 100$ hPa: $\pm 30\%$ ; $100 - 1000$ hPa: $\pm 50\%$
Bakeout temperature max. at the flange	180 °C   356 °F   453 K
Cold cathode sensor control	Cold Cathode sensor can be switched on and off via interface
Identification resistor	11.1 kΩ (Pirani); 9.1 kΩ (Cold Cathode and Pirani)
Interface: Connection	Digital RS-485; M12 f, 5-pole; Analog 0-10 V; 2 SP; M12 f, 8-pole
Materials in contact with media	Tungsten, stainless steel, nickel, molybdenum, glass
Measurement range max.	1,000 hPa   750 Torr   1,000 mbar
Measurement range min.	$5 \cdot 10^{-9}$ hPa   $3.75 \cdot 10^{-9}$ Torr   $5 \cdot 10^{-9}$ mbar
Measuring cycle	10 ms
Method of measurement	Pirani/Cold Cathode
Nominal diameter	DN 40 CF-F
Pressure max.	4,000 hPa   3,000 Torr   4,000 mbar
Protection category	IP54
Repeatability: % of measurement	$1 \cdot 10^{-8} - 1 \cdot 10^{-2}$ hPa: $\pm 7\%$ ; $1 \cdot 10^{-2} - 10$ hPa: $\pm 2\%$
Seal	Metal
Sensor cable length max.	100 m
Supply: power consumption	3.7 W
Supply: to be secured by	1 AT

Technical Data	MPT 200, DN 40 CF-F, RS-485, analog
Supply: Voltage	24 V DC
Temperature: Operating	5-60 °C   41-140 °F   278-333 K
Temperature: Storage	-40-65 °C   -40-149 °F   233-338 K
Weight	850 g

Order number	
Pirani/Cold Cathode combination MPT 200 (5 · 10 <sup>-9</sup> – 1000 hPa)	PT R40 351

Accessories	
<b>Accessories CenterLine gauges and controllers</b>	
Centering ring, with poral filter, FPM/stainless steel, DN 40 ISO-KF	PF 117 240 -T
<b>Adapter and power switching components</b>	
Adapter RS-485, M12, 4-pole - D-sub socket, 9-pole, 0.2 m	PT 348 133 -T
Connection cable, RS-485, M12/D-sub 9-pole, 3 m	PT 348 223 -T
M12 m plug 4-pole with screw terminals RS-485	PT 348 106 -T
M12 m plug 8-pole with screw terminals DigiLine AR	PT 348 107 -T
<b>Interface and extension cables</b>	
Interface cable, M12 m straight/M12 m straight, 3 m	PM 061 283 -T
<b>Mains- and supply cables</b>	
Supply cable DigiLine, M12, 4-pole to TPS, 3 m	PT 348 163 -T
<b>Measuring and interface cable</b>	
Gauge cable DigiLine xPT 200 AR to TPG 2xx, 3 m	PT 348 250 -T
<b>RS-485</b>	
Connector M12 to RS-485	PM 061 270 -X
Power separator for RS-485	PT 348 132 -T
PV TurboControl - Software for Pfeiffer Vacuum products with PV protocol	PM 061 741
Termination resistor for RS-485	PT 348 105 -T
USB converter to RS-485 interface	PM 061 207 -T
Y-Connector M12 to RS-485	P 4723 010
<b>Soft- and Firmware</b>	
DokuStar Plus software, 16 channels	PT 882 501
<b>TPS-19" rack module</b>	
TPS 111, mains pack 19" rack module 3HU	PM 061 344 -T
<b>TPS wall rail fitting</b>	
TPS 110, mains pack for wall/standard rail fitting	PM 061 340 -T