



HiPace[®] 1500

Powerful turbopumps with pumping speeds of up to 1450 l/s.





Similar Image

HiPace® 1500 U with TC 1200, DN 250 ISO-F, upside down version

- Powerful turbopump with a pumping speed of up to 1450 l/s for N₂
- DN 250 ISO-F flange
- Integrated TC 1200 drive electronics with power supply
- Integrated sealing gas system with electric sealing gas valve 24 V DC
- Cooling: Water cooling
- Installation orientation: Upside-down (90° - 180°)
- Protection Class: IP 54
- Interfaces: RS-485, Remote (Profibus/DeviceNet on request)
- Extensive accessories expand the range of applications

C = Corrosive gas version

U = Upside-down installation orientation

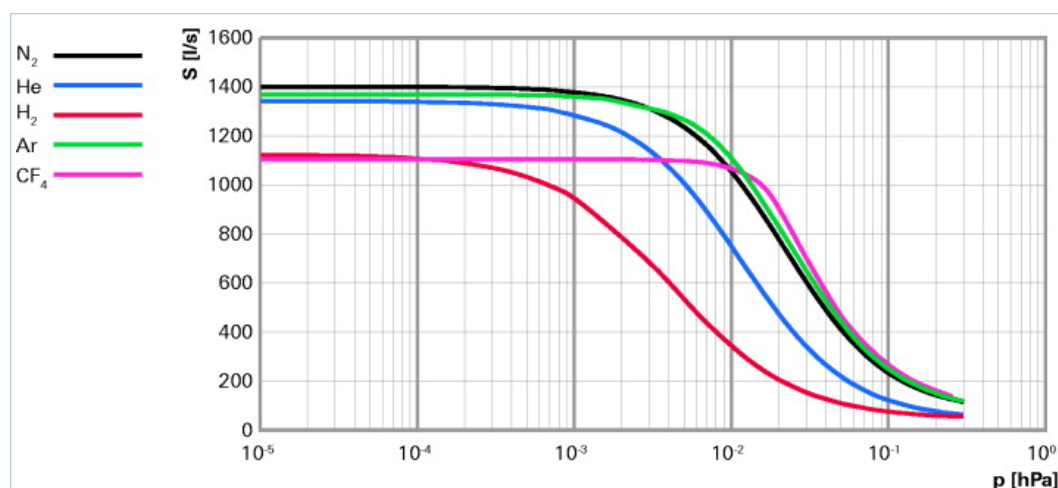

Dimensions

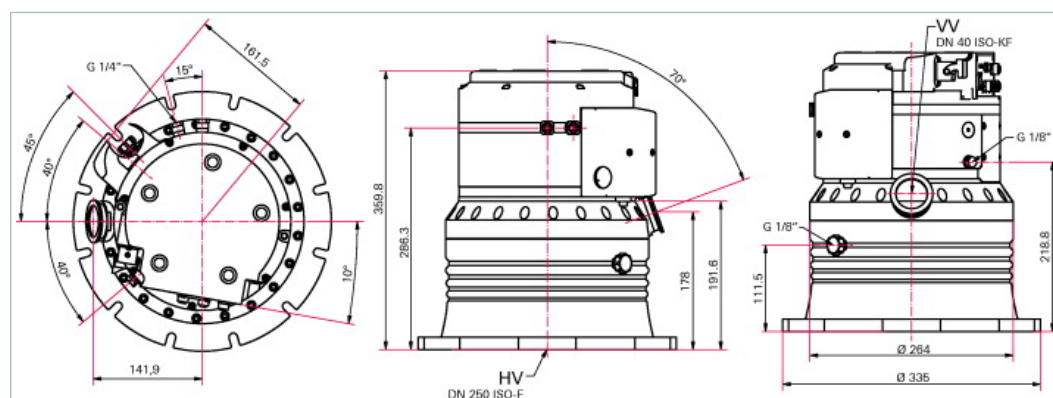

Technical Data

HiPace® 1500 U with TC 1200, DN 250 ISO-F, upside down version

Bearing	Hybrid
Compression ratio for Ar	$> 1 \cdot 10^8$
Compression ratio for H ₂	$6 \cdot 10^3$
Compression ratio for He	$2 \cdot 10^5$
Compression ratio for N ₂	$> 1 \cdot 10^8$
Cooling method, standard	Water

Technical Data		HiPace® 1500 U with TC 1200, DN 250 ISO-F, upside down version	
Cooling water consumption		100 l/h	
Cooling water temperature		15-35 °C 59-95 °F 288-308 K	
Electronic drive unit		with TC 1200	
Flange (in)		DN 250-ISO-F	
Flange (out)		DN 40 ISO-KF	
Fore-vacuum max. for N ₂		2 hPa 1.5 Torr 2 mbar	
Gas throughput at full rotational speed for Ar		11 hPa l/s 8.25 Torr l/s 11 mbar l/s	
Gas throughput at full rotational speed for H ₂		> 30 hPa l/s > 22.5 Torr l/s > 30 mbar l/s	
Gas throughput at full rotational speed for He		> 30 hPa l/s > 22.5 Torr l/s > 30 mbar l/s	
Gas throughput at full rotational speed for N ₂		20 hPa l/s 15 Torr l/s 20 mbar l/s	
Integrated power supply		yes	
Interfaces		RS-485, Remote	
Mounting orientation		Upside down (90°-180°)	
Operating voltage		100-120/200-240 V AC, 50/60 Hz	
Particulate matter		yes	
Permissible magnetic field max.		6 mT	
Protection category		IP 54	
Pumping speed for Ar		1350 l/s	
Pumping speed for H ₂		1150 l/s	
Pumping speed for He		1350 l/s	
Pumping speed for N ₂		1400 l/s	
Rotation speed ± 2 %		37800 min ⁻¹	
Run-up time		2.5 min	
Sound pressure level		≤ 50 dB (A)	
Ultimate pressure according to PNEUROP		< 1 · 10 ⁻⁸ hPa < 7.5 · 10 ⁻⁹ Torr < 1 · 10 ⁻⁸ mbar	
Venting connection		G 1/8"	
Weight		30 kg 66.14 lb	
Order number			
HiPace® 1500		PM P04 064	

Accessories	
Accessory for TC 400/1200 and TM 700	
Y-connector, shielded, M12 for accessories	P 4723 013
Adapter and control cables	
Control cable for pumping stations 0.7 m	PM 061 675 AT
HiPace - ACP connection cable	PM 071 142 -X
Control and display units	
Accessories package for HPU 001/PC	PM 061 005 -T
DCU 002, Display Control Unit	PM 061 348 -T
HPU 001, Handheld Programming Unit	PM 051 510 -T
DN ISO-F, Mounting kit	
Mounting kit for DN 250 ISO-F, including coated centering ring, hexagon screws	PM 016 480 -T
Mounting kit for DN 250 ISO-F, including coated centering ring, protective screen, hexagon screws	PM 016 482 -T
Mounting kit for DN 250 ISO-F, including coated centering ring, protective screen, stud screws	PM 016 487 -T
Mounting kit for DN 250 ISO-F, including coated centering ring, splinter shield, hexagon screws	PM 016 481 -T
Mounting kit for DN 250 ISO-F, including coated centering ring, splinter shield, stud screws	PM 016 486 -T
Mounting kit for DN 250 ISO-F, including coated centering ring, stud screws	PM 016 485 -T
DN ISO-K / -F, sealings, splinter shields, protection screens	
Centering ring with multifunction coating, DN 250 ISO-K/-F	PM 016 225 -U
Centering ring with multifunction coating and integrated protection screen, DN 250 ISO-K/-F	PM 016 227 -U
Centering ring with multifunction coating and integrated splinter shield, DN 250 ISO-K/-F	PM 016 226 -U
Fore-vacuum safety valves	
TVV 001 fore-vacuum safety valve, 115 V AC	PM Z01 206
TVV 001 fore-vacuum safety valve, 230 V AC	PM Z01 205
Interface and extension cables	
Interface cable, M12 m straight/M12 m straight, 3 m	PM 061 283 -T
Mains cables	
Mains cable 115 V AC, NEMA 5-15 to HAN 3A, 3 m	PM 061 187 -X
Mains cable 208 V AC, NEMA 6-15 to HAN 3A, 3 m	P 4564 309 HB
Mains cable 230 V AC, CEE 7/7 to HAN 3A, 3 m	P 4564 309 HA
Relay boxes	
Relay box, shielded, for backing pumps, 1-phase 20 A for TC 400/1200, TM 700 and TCP 350, M12	PM 071 285 -X
RS-485	
USB converter to RS-485 interface	PM 061 207 -T
Y-Connector M12 to RS-485	P 4723 010
Sealing gas	
Sealing gas throttle for HiPace 400/700/800 P and C version and HiPace 1200 - 2300	PM Z01 318
Sealing gas valve, shielded, HiPace 400/700/800 P and C with TC 400 and HiPace 1200 - 2300 with TC 1200	PM Z01 313
Venting accessory with small flange, G 1/8", hoses, air drier	
TTV 001, dryer for venting turbopumps	PM Z00 121

Accessories	
Venting valve (normally closed)	
Venting valve, shielded, 24 V DC, G 1/8", for connection to TC 400/1200 and TM 700	PM Z01 291