



# HiPace<sup>®</sup> 700 H with TC 400, DN 160 CF-F





Similar Image

## HiPace® 700 H with TC 400, DN 160 CF-F

- Compact yet powerful turbopump with a pumping speed of up to 685 l/s for N<sub>2</sub>
- Maximum vacuum performance with minimum power consumption
- Integrated TC 400 drive electronics
- For installation in any orientation
- Integrated, powerful cooling system
- DN 160 CF-F flange for demanding UHV applications

### Dimensions

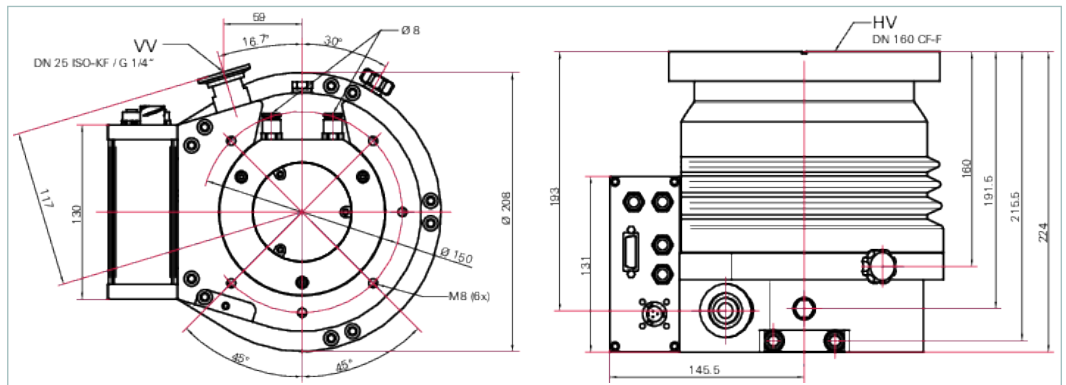

Technical Data	HiPace® 700 H with TC 400, DN 160 CF-F
Bearing	Hybrid
Compression ratio for Ar	$> 1 \cdot 10^{13}$
Compression ratio for H <sub>2</sub>	$2 \cdot 10^7$
Compression ratio for He	$1 \cdot 10^9$
Compression ratio for N <sub>2</sub>	$> 1 \cdot 10^{13}$
Cooling method, optional	Air
Cooling method, standard	Water
Cooling water flow	100 l/h
Cooling water flow, max	100 l/h
Cooling water flow, min	100 l/h
Cooling water temperature	15-35 °C   59-95 °F   288-308 K
Electronic drive unit	with TC 400
Flange (in)	DN 160 CF-F
Flange (out)	DN 25 ISO-KF
Fore-vacuum max. for N <sub>2</sub>	22 hPa   16.5 Torr   22 mbar
Gas throughput at full rotational speed for Ar	2 hPa·l/s
Gas throughput at full rotational speed for H <sub>2</sub>	14 hPa·l/s
Gas throughput at full rotational speed for He	18 hPa·l/s
Gas throughput at full rotational speed for N <sub>2</sub>	3.5 hPa·l/s
I/O interfaces	RS-485, Remote
Mounting orientation	Any
Permissible magnetic field max.	6 mT
Protection category	IP54
Pumping speed for Ar	665 l/s
Pumping speed for H <sub>2</sub>	555 l/s
Pumping speed for He	655 l/s
Pumping speed for N <sub>2</sub>	685 l/s
Rotation speed ± 2 %	49,200 rpm   49,200 min <sup>-1</sup>
Rotation speed variable	60 – 100 %
Run-up time	2 min

Technical Data		HiPace® 700 H with TC 400, DN 160 CF-F
Sound pressure level		≤ 50 dB(A)
Ultimate pressure		1 · 10 <sup>-10</sup> hPa   7.5 · 10 <sup>-11</sup> Torr   1 · 10 <sup>-10</sup> mbar
Venting connection		G 1/8"
Weight		17.7 kg   39.02 lb
Order number		
HiPace® 700 H		PM P05 751

Accessories	
<b>Adapters (electrical) PV-Can</b>	
TIC 010, Adapter for two sensors	PT R70 000
<b>Adapters (electrical) Remote</b>	
Y-connector, shielded, M12 for accessories	P 4723 013
<b>Adapters (electrical) RS-232/485</b>	
Termination resistor for RS-485	PT 348 105 -T
Power separator for RS-485	PT 348 132 -T
<b>Cables Backing pump control cables</b>	
Control cable for pumping stations 0.7 m	PM 061 675 AT
HiPace – ACP connection cable	PM 071 142 -X
<b>Cables Connection cables</b>	
Connection cable for HiPace with TC 400/TM 700 to power supply pack TPS/DCU 310/311/400/401	PM 061 352 -T
<b>Cables Mains cables / Power cords</b>	
Mains cable 208 V AC, NEMA 6-15 to C13, 3 m	P 4564 309 ZF
<b>Control Devices Backing pump</b>	
Relay box for backing pumps, single phase 20 A for TC 400 and TCP 350, M12 plug	PM 061 375 -T
Relay box, shielded, for backing pumps, 1-phase 7 A for TC 400/1200, TM 700 and TCP 350, M12	PM 071 284 -X
<b>Control Devices Power supplies and control displays</b>	
Accessories package for HPU 001/PC	PM 061 005 -T
TPS 400, power supply pack 48 V DC, for wall/standard rail fitting	PM 061 343 -T
TPS 401, power supply pack 48 V DC, 19" partial plug-in 3HU	PM 061 347 -T
Front panel kit for TPS 401	PM 061 396 -T
DCU 400, Display control unit incl. power supply pack 19"	PM C01 823
<b>Control Units without Power supply</b>	
HPU 001, Handheld programming unit	PM 051 510 -T
DCU 002, Display Control Unit	PM 061 348 -T
<b>Cooling Air cooling</b>	
Air cooling for HiPace 400/700 and 800 with TC 400	PM Z01 303
<b>FKM cut from sheet material</b>	
Elastomer seal, FKM, DN 160 CF	402DFL160-S2
<b>FKM with centering lip; heat-molded</b>	
Elastomer seal, FKM, DN 160 CF	402DFL160-Z
<b>Heating Heating jackets</b>	
Heating jacket for HiPace 400/700/800 with TC 400, 230 V AC, safety plug	PM 061 369 -T
Heating jacket for HiPace 400/700/800 with TC 400, 208 V AC, UL plug	PM 061 370 -T
Heating jacket for HiPace 400/700/800 with TC 400, 115 V AC, UL plug	PM 061 371 -T
<b>Monitoring Pressure Sensors</b>	
RPT 010, Digital Piezo/Pirani Sensor	PT R71 100
IKT 010, Digital cold cathode sensor, low current	PT R72 100
IKT 011, Digital cold cathode sensor, high current	PT R73 100
<b>Monitoring Sealing gas monitoring units</b>	
Sealing gas monitoring unit G 1/8"	PM 016 911 -U

<b>Accessories</b>	
<b>Mounting CF-F, Mounting kits</b>	
Hexagon Screw Set for Flanges with Through-Holes, DN 160 CF-F	PM 016 691 -T
Set of stud screws for flanges with a threaded hole, DN 160 CF-F	PM 016 693 -T
Set of stud screws for flanges with through-hole, DN 160 CF-F	PM 016 735 -T
<b>Mounting Wall rail fittings</b>	
Wall rail fitting for TPS 110/180/310/400	PM 061 392 -T
<b>OFHC Copper (Oxygen Free)</b>	
Copper Gasket, OFHC-copper, DN 160 CF	490DFL160-S5
<b>OFHC Copper (Oxygen Free), Silver-plated</b>	
Copper Gasket, Silver-Plated, DN 160 CF	490DFL160-S-S5
<b>OFHC Copper (Oxygen Free), Silver-plated, Vacuum-annealed</b>	
Copper Gasket, Silver-plated, Vacuum-Annealed, DN 160 CF	490DFL160-S-G-S5
<b>OFHC Copper (Oxygen Free), Vacuum-annealed</b>	
Copper Gasket, Vacuum-annealed, DN 160 CF	490DFL160-G-S5
<b>Protection CF-F, splinter shields, protection screens</b>	
Splinter shield for turbopumps, DN 160 CF-F	PM 016 318
Protection screen for DN 160 CF-F	PM 016 339
<b>Protection Sealing gas throttles</b>	
Sealing gas throttle for HiPace 300	PM Z01 317
<b>Turbopumps</b>	
Mains cable 230 V AC, CEE 7/7 to C13, 3 m	P 4564 309 ZA
Mains cable 115 V AC, NEMA 5-15 to C13, 3 m	P 4564 309 ZE
Y-Connector M12 to RS-485	P 4723 010
USB converter to RS-485 interface	PM 061 207 -T
<b>Turbopumps/Masurement</b>	
Interface cable, M12 m straight/M12 m straight, 3 m	PM 061 283 -T
<b>Valves Fore-vacuum safety valves</b>	
TVV 001, fore-vacuum safety valve, 230 V AC	PM Z01 205
TVV 001, fore-vacuum safety valve, 115 V AC	PM Z01 206
<b>Valves Sealing gas valves, shielded (normally closed)</b>	
Sealing gas valve, shielded for HiPace 300 with TC 400 and TM 700, TCP 350	PM Z01 312
<b>Venting Venting accessories</b>	
TTV 001, Drier for Venting Turbopumps	PM Z00 121
<b>Venting Venting valves (normally closed)</b>	
Venting valve, shielded, 24 V DC, G 1/8", for connection to TC 400/1200 and TM 700	PM Z01 291
<b>Vibration Reduction Vibration dampers</b>	
Vibration damper for HiPace DN 160 CF-F	PM 006 493 -X

# 上海伯东真空产品事业部

## 上海伯东--您理想的真空合作伙伴！

伯东公司成立于 1953 年，全球范围内有一千七百名员工。伯东企业(上海)有限公司(www.hakuto-vacuum.cn)主要从事半导体设备、电子零部件加工、销售及相关服务工作，集团年营业额约为 100 亿人民币。伯东公司在国内主要城市：北京、苏州、广州、深圳、成都及厦门设有营业据点。

上海伯东真空产品事业部秉承为广大中国客户提供世界一流的真空产品、推动中国真空工艺发展、承担企业社会责任为经营理念，已累计为超过 10,000 家企业提供真空服务，覆盖工业、半导体、镀膜、科研和分析行业。

上海伯东代理品牌包含：德国 Pfeiffer 全系列真空产品、美国 KRI 离子源、美国 Brooks Polycold 制冷机，美国 HVA 真空阀门，美国 inTEST (Temptronic) 高速温度循环测试机，离子蚀刻机，英国原子力显微镜, 真空镀膜系统及配套真空零配件等。

上海伯东作为国际知名真空品牌指定授权代理商，全权负责在中国地区的销售和维修服务，100% 使用原厂进口零部件以及国外受训维修工程师；拥有完全的拆解，维修，校正能力并提供 24 小时在线服务。

### ● 营业维修服务据点



伯东企业（上海）有限公司 HAKUTO ENTERPRISES (SHANGHAI) LTD.

TEL: (86) 21-5046-3511

FAX: (86) 21-5046-1490

MOL: 1391-883-7267

**伯东企业（上海）有限公司 销售及售后服务中心**

上海浦东新区新金桥路 1888 号 36 号楼 7 楼 702 室

电 话：+86-21-5046-3511

传 真：+86-21-5046-1490

官 网：<http://www.hakuto-vacuum.cn>

24 h 售后维修专线：1381-880-1372

**伯东企业（上海）有限公司 北京办事处 销售中心**

北京丰台区芳群园四区 22 号楼金城中心 705 室

电 话：+86-010-8768-4988

传 真：+86-21-5046-1490

官 网：<http://www.hakuto-vacuum.cn>

**伯东企业（上海）有限公司 深圳办事处 销售中心**

深圳市罗湖区宝安南路 1036 号鼎丰大厦 501

电 话：+86-0755-2547-3988.643

传 真：+86-21-5046-1490

官 网：<http://www.hakuto-vacuum.cn>

**伯东国际通商股份有限公司 销售及售后服务中心**

台北市中山区八德路二段 308 号 6 楼

电 话：+886-2-8772-8910

传 真：+886-2-8772-8918

新竹市埔顶路 25 号 8 楼之一

电 话：+886-3-5679508

传 真：+886-3-5670049

官 网：<http://www.hakuto-vacuum.com.tw>

