



HiPace® 300 M





Similar Image

HiPace® 300 M with TM 700, DeviceNet, DN 100 ISO-F

- 5-axis magnetically levitated turbopump with a pumping speed of 255 l/s for N₂
- Integrated digital magnetic bearing controller TM 700
- Installation in any orientation; flexible through connectivity of up to 4 accessory parts
- With integrated water cooling for maximum gas throughput
- Interface: DeviceNet and Remote
- The turbopump features extremely low vibration and is oil-free
- With patented In-field sensor calibration
- Including venting valve and patented "pulsed venting"
- Protection Class: IP 54
- Extensive accessories expand the range of applications

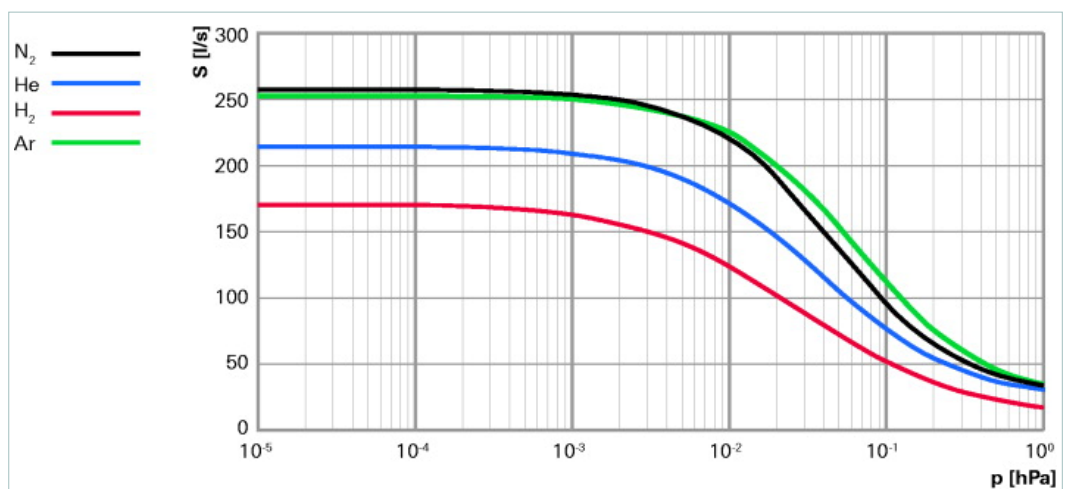

Dimensions

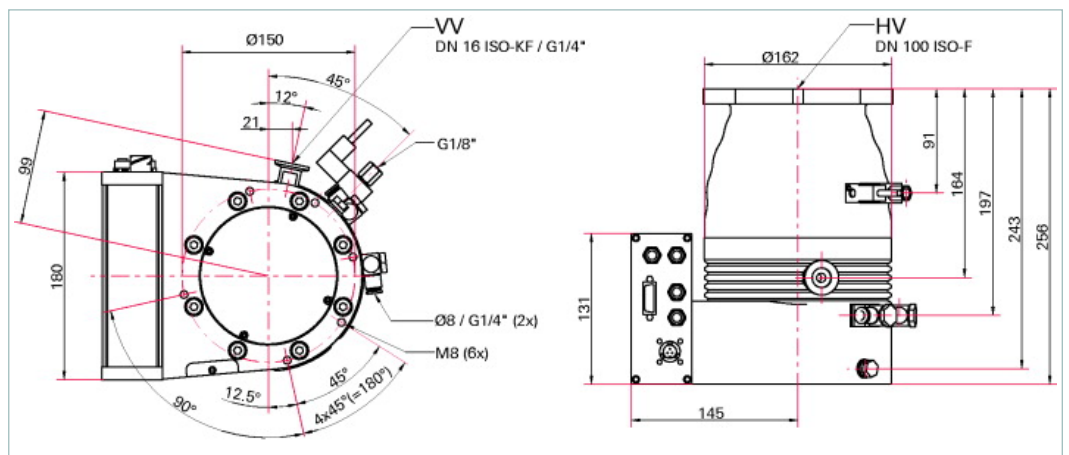

Technical Data

HiPace® 300 M with TM 700, DeviceNet, DN 100 ISO-F

Bearing	Magnetically Levitated
Compression ratio for Ar	$> 1 \cdot 10^{11}$
Compression ratio for H ₂	$5 \cdot 10^5$
Compression ratio for He	$> 1 \cdot 10^8$
Compression ratio for N ₂	$> 1 \cdot 10^{11}$
Cooling method, optional	Air, convection
Cooling method, standard	Water

Technical Data		HiPace® 300 M with TM 700, DeviceNet, DN 100 ISO-F	
Cooling water consumption		80 l/h	
Cooling water temperature		15-35 °C 59-95 °F 288-308 K	
Electronic drive unit		with TM 700	
Flange (in)		DN 100 ISO-F	
Flange (out)		DN 16 ISO-KF	
Fore-vacuum max. for N ₂		20 hPa 15 Torr 20 mbar	
Gas throughput at 0.1 hPa HV for Ar		11 hPa l/s 8.25 Torr l/s 11 mbar l/s	
Gas throughput at 0.1 hPa HV for H ₂		5 hPa l/s 3.75 Torr l/s 5 mbar l/s	
Gas throughput at 0.1 hPa HV for He		8 hPa l/s 6 Torr l/s 8 mbar l/s	
Gas throughput at 0.1 hPa HV for N ₂		10 hPa l/s 7.5 Torr l/s 10 mbar l/s	
Gas throughput at full rotational speed for Ar		13 hPa l/s 9.75 Torr l/s 13 mbar l/s	
Gas throughput at full rotational speed for N ₂		28 hPa l/s 21 Torr l/s 28 mbar l/s	
Interface, extended		DeviceNet	
Interfaces		RS-485, Remote, DeviceNet	
Low vibrations		yes	
Mounting orientation		in any orientation	
Operating voltage		48 (± 5 %) V DC	
Permissible magnetic field max.		5 mT	
Protection category		IP 54	
Pumping speed for Ar		250 l/s	
Pumping speed for H ₂		170 l/s	
Pumping speed for He		215 l/s	
Pumping speed for N ₂		255 l/s	
Rotation speed ± 2 %		60000 min ⁻¹	
Rotation speed variable		20-100 %	
Run-up time		< 2 min	
Sound pressure level		≤ 45 dB (A)	
Ultimate pressure according to PNEUROP		< 1 · 10 ⁻⁷ hPa < 7.5 · 10 ⁻⁸ Torr < 1 · 10 ⁻⁷ mbar	
Venting connection		G 1/8"	
Weight		13.4 kg 29.54 lb	
Order number			
HiPace® 300 M		PM P03 957	

Accessories	
Accessory for TC 400/1200 and TM 700	
Mains power socket, angled, for TC 400/TM 700	P 4723 101
Mains power socket TC 400/TM 700, straight	P 4723 100
Adapter and control cables	
HiPace - ACP connection cable	PM 071 142 -X
Air cooling	
Air cooling, shielded, for HiPace 300 with TC 400 PB	PM Z01 362
Air cooling for HiPace 400/700 and 800 with TC 400	PM Z01 303
Connection cables	
Connection cable for HiPace with TC 400/TM 700 to power supply TPS/DCU 310/311/400/401	PM 061 352 -T
Control and display units	
Accessories package for HPU 001/PC	PM 061 005 -T
DCU 002, Display Control Unit	PM 061 348 -T
HPU 001, Handheld Programming Unit	PM 051 510 -T
DCU with integrated power supply	
DCU 400, Display control unit incl. power supply	PM C01 823
DN ISO-F, Mounting kit	
Mounting kit for DN 100 ISO-F, including coated centering ring, hexagon screws	PM 016 450 -T
Mounting kit for DN 100 ISO-F, including coated centering ring, protection screen, stud screws	PM 016 457 -T
Mounting kit for DN 100 ISO-F, including coated centering ring, protective screen, hexagon screws	PM 016 452 -T
Mounting kit for DN 100 ISO-F, including coated centering ring, splinter shield, hexagon screws	PM 016 451 -T
Mounting kit for DN 100 ISO-F, including coated centering ring, splinter shield, stud screws	PM 016 456 -T
Mounting kit for DN 100 ISO-F, including coated centering ring, stud screws	PM 016 455 -T
DN ISO-K / -F, sealings, splinter shields, protection screens	
Centering ring with multifunction coating, DN 100 ISO-K/-F	PM 016 210 -U
Centering ring with multifunction coating and integrated protection screen, DN 100 ISO-K/-F	PM 016 212 -U
Centering ring with multifunction coating and integrated splinter shield, DN 100 ISO-K/-F	PM 016 211 -U
Fore-vacuum safety valves	
TVV 001 fore-vacuum safety valve, 115 V AC	PM Z01 206
TVV 001 fore-vacuum safety valve, 230 V AC	PM Z01 205
Interface and extension cables	
Extension cable M12 on M12	PM 061 747 -T
Interface cable, M12 m straight/M12 m straight, 3 m	PM 061 283 -T
Mains cables	
Mains cable 115 V AC, NEMA 5-15 to C13, 3 m	P 4564 309 ZE
Mains cable 208 V AC, NEMA 6-15 to C13, 3 m	P 4564 309 ZF
Mains cable 230 V AC, CEE 7/7 to C13, 3 m	P 4564 309 ZA
Power failure venting units (normally open)	
Power failure venting valve, shielded, 24 V DC, G 1/8" for connection to TC 400, TM 700 and TC 1200	PM Z01 331

Accessories	
Pressure Sensors	
IKT 010, Digital Cold Cathode Sensor, low current	PTR 72 100
IKT 011, Digital Cold Cathode Sensor, high current	PT R73 100
RPT 010, Digital Piezo/Pirani Sensor	PT R71 100
TIC 010, Adapter for two sensors	PT R70 000
Profibus	
Remote adapter for RS-485	PM 061 649 -X
Relay boxes	
Backing pump relay box, single phase 20 A, for TC 400 and TCP 350, M12 plug	PM 061 375 -T
Relay box, shielded, for backing pumps, 1-phase 20 A for TC 400/1200, TM 700 and TCP 350, M12	PM 071 285 -X
RS-485	
USB converter to RS-485 interface	PM 061 207 -T
Y-Connector M12 to RS-485	P 4723 010
Sealing gas	
Sealing gas throttle for HiPace 300	PM Z01 317
Sealing gas valve, shielded for HiPace 300 with TC 400 and TM 700, TCP 350	PM Z01 312
TPS-19" rack module	
Front panel kit for TPS 401	PM 061 396 -T
TPS 401, power supply 48 V DC, 19" partial plug-in 3HU	PM 061 347 -T
TPS wall rail fitting	
TPS 400, power supply 48 V DC, for wall/standard rail fitting	PM 061 343 -T
Venting accessory with small flange, G 1/8", hoses, air drier	
Banjo fitting	PM 016 787 -T
Banjo fitting, small	PM 143 877 -T
TTV 001, dryer for venting turbopumps	PM Z00 121
Venting valve (normally closed)	
Venting valve, shielded, 24 V DC, G 1/8", for connection to TC 400/1200 and TM 700	PM Z01 291

上海伯东--您理想的真空合作伙伴!

伯东公司成立于1953年,全球范围内有一千七百名员工。伯东企业(上海)有限公司(www.hakuto-vacuum.cn)主要从事半导体设备、电子零部件加工、销售及相关服务工作,集团年营业额约为100亿人民币。伯东公司在国内主要城市:北京、苏州、广州、深圳、成都及厦门设有营业据点。

上海伯东真空产品事业部秉承为广大中国客户提供世界一流的真空产品、推动中国真空工艺发展、承担企业社会责任为经营理念,已累计为超过10,000家企业提供真空服务,覆盖工业、半导体、镀膜、科研和分析行业。

上海伯东代理品牌包含:德国Pfeiffer全系列真空产品、美国KRI离子源、美国Brooks Polycold制冷机,美国HVA真空阀门,美国inTEST(Temptronic)高速温度循环测试机,离子蚀刻机,真空镀膜系统及配套真空零配件等。

上海伯东作为国际知名真空品牌指定授权代理商,全权负责在中国地区的销售和维修服务,100%使用原厂进口零部件以及国外受训维修工程师;拥有完全的拆解,维修,校正能力并提供24小时在线服务。



Are you looking for a
perfect vacuum solution?
Please contact us:

伯东企业(上海)有限公司
T +021 5046-3511
ec@hakuto-vacuum.cn



www.hakuto-vacuum.cn
www.hakuto-vacuum.com.tw

PFEIFFER  VACUUM

 伯東
Hakuto

