



# Okta 1000

Roots pump with a pumping speed of 590 to 1,775 m<sup>3</sup>/h:





Similar Image

## Okta 1000, Roots pump, 230/400 V, 50 Hz; 265/460 V, 60 Hz

- High-performance Roots pump with a pumping speed of 590 to 1,775 m<sup>3</sup>/h
- For mains voltage: 230/400 V, 50 Hz respectively 265/460 V, 60 Hz
- No thermal overload thanks to integral overflow valve
- For applications in the low and medium vacuum

Okta = Standard pumps with radial shaft sealing rings, housing parts made of gray cast iron or nodular graphite cast iron, flange connection in accordance with ISO-F

Okta = Standard pumps, hermetically sealed thanks to magnetic coupling, housing parts made of gray cast iron or nodular graphite cast iron, flange connection in accordance with ISO-F

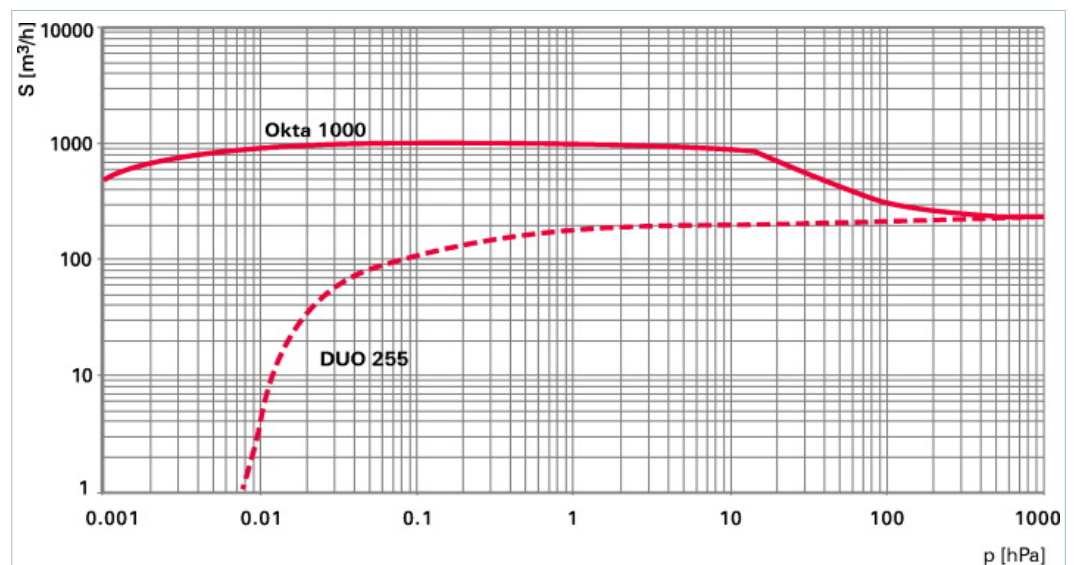

### Dimensions

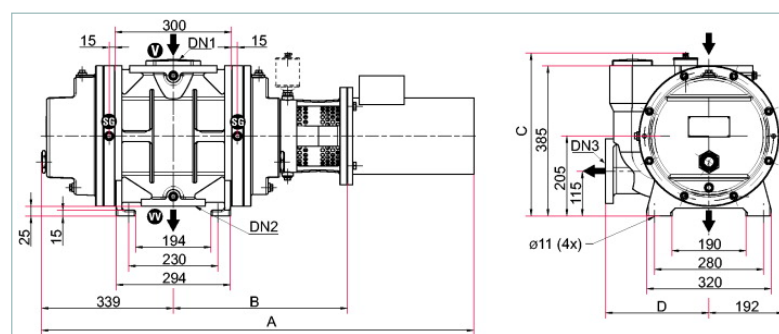

A	1112 mm
B	448 mm
C	418 mm
D	266 mm
DN 1	DN 160 ISO-F
DN 2	DN 100 ISO-F
DN 3	DN 100 ISO-F

### Technical Data

#### Okta 1000, Roots pump, 230/400 V, 50 Hz; 265/460 V, 60 Hz

Ambient temperature	5-40 °C   41-104 °F   278-313 K
Cooling method, standard	Air
Differential pressure at the overflow valve	45 hPa   33.75 Torr   45 mbar
Emission sound pressure level (EN ISO 2151) at intake pressure 10 hPa	75 dB (A)
Emission sound pressure level (EN ISO 2151) at intake pressure 1 hPa	72 dB (A)
Flange (in)	DN 160 ISO-F

Technical Data		Okta 1000, Roots pump, 230/400 V, 50 Hz; 265/460 V, 60 Hz
Flange (out)		DN 100 ISO-F
Leak rate		$1 \cdot 10^{-3}$ Pa m <sup>3</sup> /s   $7.5 \cdot 10^{-3}$ Torr l/s   $1 \cdot 10^{-2}$ mbar l/s
Mains requirement: voltage 50 Hz		230/400 V
Mains requirement: voltage 60 Hz		265/460 V
Motor protection		3TF
Nominal pumping speed		590-1775 m <sup>3</sup> /h
Nominal pumping speed at 50 Hz		1180 m <sup>3</sup> /h
Nominal pumping speed at 60 Hz		1420 m <sup>3</sup> /h
Nominal rotation speed at 50 Hz		3000 min <sup>-1</sup>
Nominal rotation speed at 60 Hz		3600 min <sup>-1</sup>
Operating fluid		P3
Operating fluid filling		2.9 l
Protection category		IP 55
Rated power 50 Hz		3.0 kW
Rated power 60 Hz		3.5 kW
Rotation speed		from 1,500 to 4,500 min <sup>-1</sup>
Rotation speed max.		4,500 min <sup>-1</sup>
Rotation speed min.		1,500 min <sup>-1</sup>
Version		Standard with motor
Weight: with motor		240 kg   529.1 lb
Order number		
Okta 1000		PP W41 000

Accessories	
<b>Accessories</b>	
Oil level monitoring 20-250 V AC for Okta 250 / M / Okta 500 / M / Okta 1000 / M / Okta 2000 / M / Okta 4000 / M / Okta 6000 / M, G 1 1/4	PK 004 930 -U
Oil level monitoring 24 V DC for Okta 250 / M / Okta 500 / M / Okta 1000 / M / Okta 2000 / M / Okta 4000 / M / Okta 6000 / M, G 1 1/4	PK 005 639 -U
<b>Adjusting elements for fastening the feet.</b>	
Setting elements for foot mounting for Okta 250 / M / Okta 500 / M / Okta 1000 / M, 35 mm	PP 041 454 -T
<b>Blank flange sets</b>	
Blank flange set (Stainless steel) for Okta 1000 / M / ATEX / Okta 2000 / M / ATEX, DN PN16/PN10	PP 043 885 -T
Blank flange set (Stainless steel) for Okta 1000 / M / Okta 2000 / M, DN ISO-K	PP 043 884 -T
Blank flange set for Okta 1000 / M / Okta 2000 / M, Stainless steel	PP 043 883 -T
<b>DN ISO-F</b>	
Mounting bolts (Stainless steel) for Okta 1000 / M / Okta 1000 / M, Okta 2000 / M, DN ISO-F	PP 043 878 -T
Mounting bolts (Zinc-plated Steel) for Okta 1000 / M / Okta 1000 / M, Okta 2000 / M, DN ISO-F	PP 043 873 -T
<b>DN ISO-K</b>	
Claw set (Stainless steel) for Okta 1000 / M / Okta 1000 / M, Okta 2000 / M, DN ISO-K	PP 043 879 -T
Claw set (Zinc-plated Steel) * for Okta 1000 / M / Okta 1000 / M, Okta 2000 / M, DN ISO-K	PP 043 881 -T
Claw set (Zinc-plated Steel) for Okta 1000 / M / Okta 1000 / M, Okta 2000 / M, DN ISO-K	PP 043 880 -T
<b>DN PN16/PN10</b>	
Mounting bolts (Zinc-plated Steel) for Okta 1000 / M / ATEX, DN PN16/PN10	PP 043 882 -T
<b>Frequency converter</b>	
Frequency converter (Complete with control box) Okta 1000 / M	PP 078 300 -T
<b>Gear chamber evacuation</b>	
Gear box exhaust (Flexible hose) for Okta 1000 / M, G 3/8 (3x)	PP 043 888 -T
Gear box exhaust (Plastic hose) for Okta 1000 / M, G 3/8 (3x)	PP 043 887 -T
<b>Oil compensating line (with oil level monitoring)</b>	
Oil compensating line with oil level monitoring for Okta 250 / M / Okta 500 / M, G 3/8 (4x), G 1 1/4 (1x)	PP 031 447 -T
<b>Purge gas kit</b>	
Sealing gas kit for Okta 250 / M / Okta 500 / M / Okta 1000 / M / Okta 2000 / M / Okta 4000 / M / Okta 6000 / M / Okta 8000 / Okta 1500 G / Okta 4000 G / Okta 8000 G, G 3/8 (4x)	PP 027 401 -T
<b>Sealing kits</b>	
Centering ring with outer ring for vacuum flange for Okta 1000 / M / Okta 2000 / M, DN ISO-F	PF 303 116 -T
Centering ring with outer ring for vacuum flange for Okta 500 / M / Okta 500 G, DN ISO-F	PF 303 110 -T
Seal kit (FKM) for Okta 1000 / M / ATEX, DN PN16/PN10	PP 043 886 -T
<b>Splinter shield</b>	
Splinter shield for Okta 1000/1000 M/1500 G/2000/2000 M	PP 031 114 -X
Splinter shield for Okta 1000/2000 AD-Series	PP 031 115 -X

Accessories	
<b>Sprayer</b>	
Sprayer DN ISO-F for Okta 1000 / M / Okta 2000 / M	PP 031 252 -T
Sprayer DN PN16/PN10 for Okta 1000 / M / Okta 2000 / M / Okta 1500 G	PP 031 243 -T
<b>Temperature sensor</b>	
Temperature sensor for Okta 250 / M / Okta 500 / M / Okta 1000 / M / Okta 2000 / M / Okta 4000 / M / Okta 6000 / M / Okta 500 G / Okta 1500 G / Okta 4000 G, G 3/8	PP 041 457 -T
<b>Consumables</b>	
P3, mineral oil, 1 l	PK 001 106 -T
P3, mineral oil, 5 l	PK 001 107 -T